

A large, abstract watercolor splash in shades of blue and green, with several white bird silhouettes flying above it. The splash is centered on the page and serves as a background for the main text.

*Creativity
is the fun of putting
together
unexpected ideas*

A watercolor illustration featuring a large, dark green tree with a thick trunk and a wide, flat canopy, situated on a dark, rounded hill. The background is a soft, light blue sky with white, wispy clouds. Several birds are depicted in flight, scattered across the sky. The overall style is soft and artistic, with a focus on natural elements.

*Thoughtful homes
in the midst of serenity.*

Imagine a place where you can wake up to an enchanting sunrise and not the noisy neighbours,

Where you can take a break from the concrete life and stretch your mind,

Where you can find your own space within the four walls,

Where life is made of finer details and utmost care,

Where moments turn into memories.

Welcome to

ethos 
crafted around you

*privacy of a villa
meets convenience of a society.*



Privacy-Villament

No common walls, No wasted corners, and open from more than 3 sides

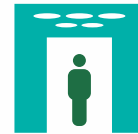

Designer Lounge

Stylish designer entrance lobby will come with formal sofa seating, False ceiling and designer lights to attend your outsider visitors



Well-lit and Ventilated Spaces

Every apartment is open from more than three sides to give you better ventilation and more light



Top most Security is our Priority

Entrance lobby equipped with bio-metric thumb access system.

CCTV surveillance for common area



Ample Lifts

Every building is equipped with 3 lifts which means no more waiting even if you stay on the last floor



Garbage Chute

Wet and Dry garbage chute provision on every floor for easy disposal of waste materials.

3 towers of
14 floors each

2 BHK personal
abodes

158 private
apartments



*A space as big
as your dreams.*

At Ethos, every house is carefully crafted and thoughtfully planned so you have enough space to stretch your mind and enough room to live leisurely. Every apartment is especially designed to give you a larger than life experience.



Store room with granite racks



Dedicated temple room



Walk-in closet attach to master bedroom



Solar water connection to master bathroom



Master switch to control all the electric connections at your own ease



- Video Door Phone (VDP)
- Unlock maindoor through VDP
- Multi-Apartment Intercom system
- Video Door Phone connected to security



Where a house becomes a home.



*Harmonious
community living.*

Open Amenities



Mini cricket ground and pitch with corner seating's



Community Temple



Half Basket ball court



Childrens play area



Student pick-up and drop spot with seating and barriers



Open lawns with surrounding shadow trees



Jogging Track



Mini Stage

Indoor Amenities



Home Theater



Carrom



Chess



Pool Table



Table Tennis



Gymnasium



Yoga



Amenities



Beauty lies in details.

External Specifications



CONCRETE AND MANSORY

- M30 designed and lab tested concrete for RCC design
 - Mansory in energy saving light weight blocks
 - Earthquake resistance building design
 - Single coat superior plaster finish
-



ENTRANCE AND SECURITY

- Modern design entrance gate
 - Common area under CCTV surveillance with recording
 - Video door phone connected to security cabin at entrance of building lobby
 - Multi apartment Intercom facility
 - Security guard cabin
 - Common area and lifts with generator backup
-



ROADS AND PARKING

- 12M Internal trimix road
 - Well-built concrete side margins
 - Parking floor in paving blocks
-



GREEN

- Side walk and side margins with beautiful plantation
- More than 50 shadow or palm trees



OTHERS

- PCMC water connectivity (on availability)
 - Provision of borewell water and rain water harvesting
 - Wheelchair friendly development
 - Driver/ outsiders visitor restroom
 - STP Plant
 - Use of Eco-friendly construction materials to reduce carbon footprints
-



FIRE FIGHTING

- PCMC compliant Fire-fighting equipment and fire refuge area
-



ELEVATORS

- Two automatic passenger elevators
- One Stretcher/ goods elevator

Internal Specifications

TILES

- 600MM X 600MM double glazed flooring for entire flat
 - 24" X 12" kitchen wall tiles
 - 24" X 12" bathroom wall tiles upto lental height
 - 12' X 12" or 16" X 16" anti skid bathroom floorings
 - 16" X 16" ceramic and equivalent anti skid terrace flooring
 - Entrance and lift lobby in designer tiles or Italian/ Indian stone finish
 - Anti skid flooring in staircase
-

ELECTRICAL

- Legrand made switches
 - Point Provision for split air-conditioners for both bedrooms
 - Fire resistant cabling
 - Each flat with ELCB (earth leakage circuit breaker) for electrical safety
 - Single phase power supply
 - Inverter back-up provision
 - Back-up power generator for all elevators & for common lighting
 - TV/ Cable points for living room
 - WP, Refrigerator, Exhaust fan and few more necessary electrical power points in kitchen
-

PAINTS

- APEX or similar range building exterior paint
- OBD for internal flat
- Gypsum/ POP finish walls

KITCHEN AND TERRACES

- Highest quality granite kitchen platform with SS sink
 - Terrace railing in combination of S.S + Glass and BBW
 - Kitchen dry terrace with provision for washing machine
 - Ceramic flooring for attached terraces
-

DOORS AND WINDOWS

- Security video door phone connected with security
 - Wide wooden door frames with both side laminates
 - Stone frames with FRP/ PVC long life doors for bathrooms
 - Designer mortise lock for internal doors
 - Attractive fittings for main door
 - Main door with designer skin panel
 - Wooden frame and door with both side laminates
 - Large windows for better ventilation and view
 - Powder coated aluminum sliding windows with mosquito net
 - Safety grills for windows
-

PLUMBING

- Jaguar or Grohe range of C.P. fittings
- Exhaust fan provision in bathrooms
- Designer tiles upto lintel level
- Counter top/ flat ceramic wash basin
- Hot and cold mixer for shower area
- Designer sanitaryware



Designer entrance lobby.

Behind the picture

Ethos makes every corner count with its no-wastage-of-space design, giving you enough room to find your own space. Every home is carefully planned keeping its practicality and usability in mind. For example, you won't find any wasted corner or a cluttered space inside. Here, every square foot is thoughtfully crafted to give you maximum utility space without compromising on comfort.

Cut Section 1



Cut Section 2.1

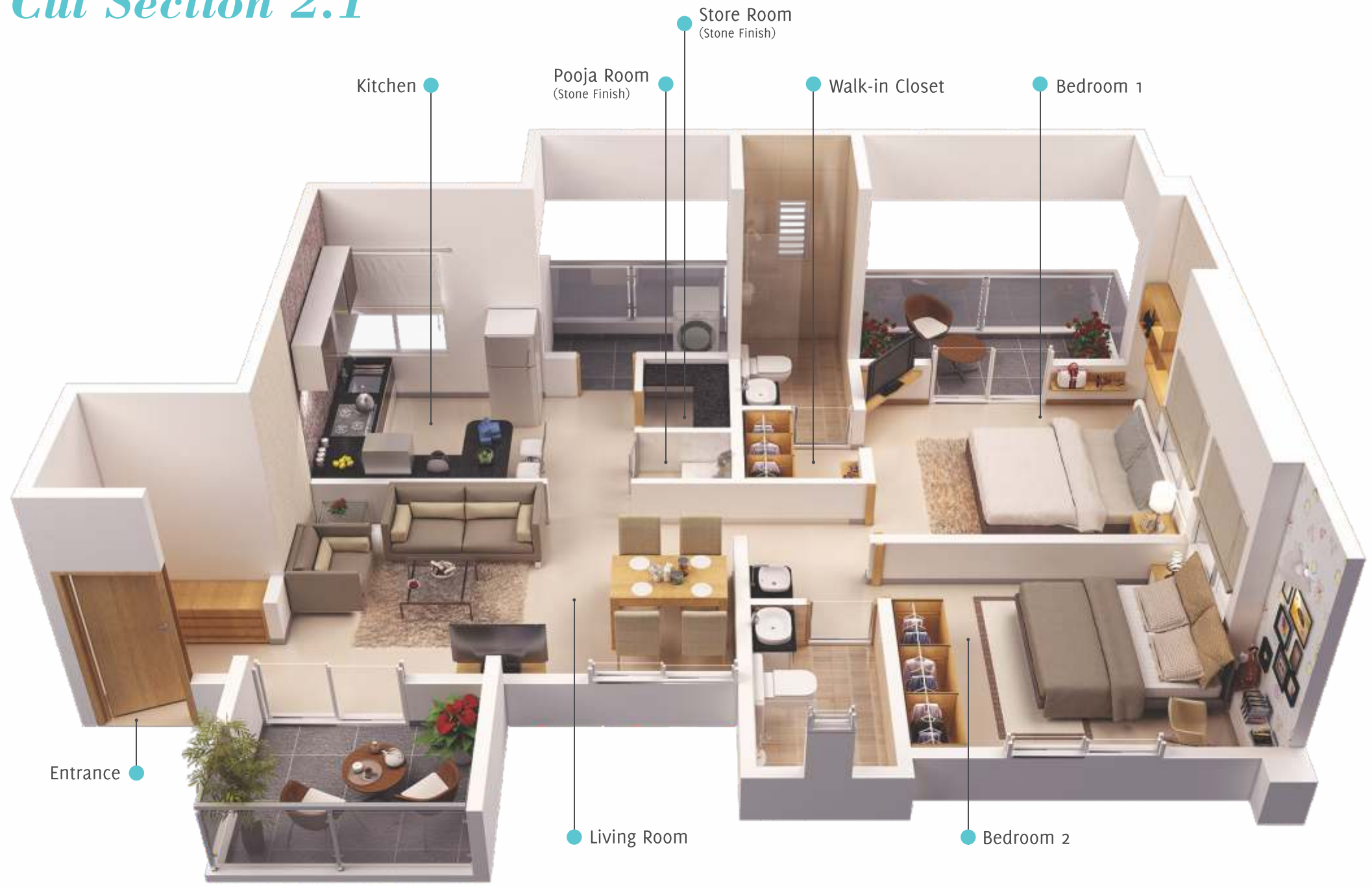

Cut Section 2.2



Find your space in the midst of city

Located in the bustling suburbs of Wakad, Ethos brings the convenience to your door step and offers you an ideal community living in the heart of the city. With schools, colleges and restaurants in vicinity, proximity to Hinjewadi IT park and accessible to Bhosari and Chakan area, Ethos stands out as an ideal residential pasture in the midst of city hustle. More to this, there are many upcoming/ underconstruction Malls & Commercial spaces in Malungi, close to Ethos

Who said, you can't enjoy the convenience of the city and the privacy of a villa in the same place.

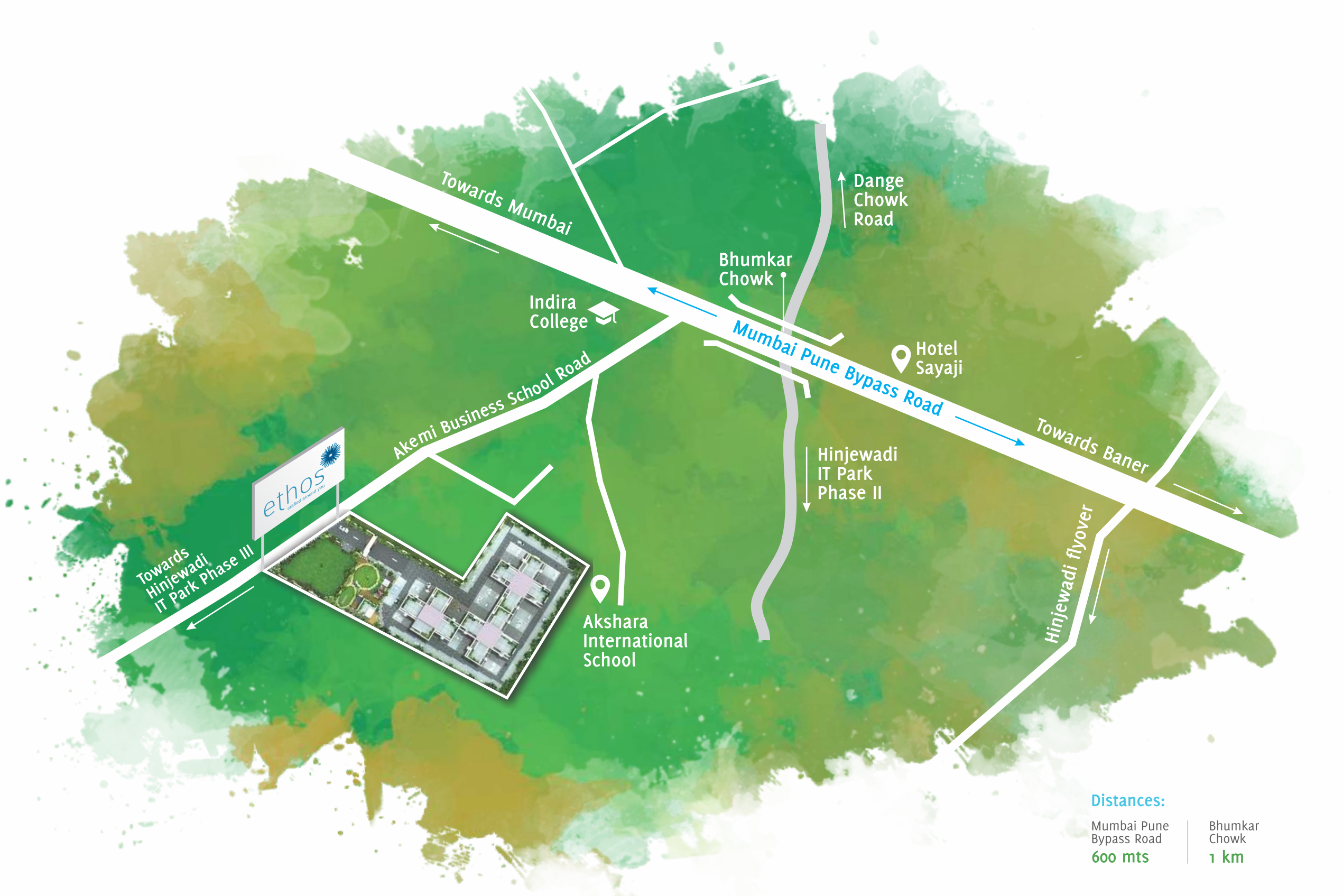

ethos
certified around you



Distances:

Mumbai Pune Bypass Road
600 mts

Bhumkar Chowk
1 km

About *Golecha Realty Corporation*



Since its inception in 1999, GRCo has carved out its own way in real estate fraternity. Previously known as 'PRG Development and Investments', GRCo has left its indelible mark in PCMC & PCNTDA area. GRCo is headed by Mr. Vijay Golecha, Chairman Golecha Group and Mr. Prashant Golecha, Head Construction division who has done his MS in Construction Management, University of Reading, (U.K) and his Masters in Real Estate Development (Arizona State University, USA). Today, GRCo stands tall on the successful completion and overwhelming customer satisfaction for their recent projects in real estate industry.

The fundamentals of our design come from the basic principle of golden ratio which is depicted through our

logo. We believe every house should be well-ventilated, well-lit and thoughtfully planned so there are no wasted corners or unnecessary walls. It is these basic fundamentals that make our living more comfortable and pleasurable. That's the reason why we at GRCo strongly believe that the mind always comes before the matter. And it is the thought behind everything that counts.

Our strength lies in our core values like transparency, non-compromising attitude when it comes to quality, innovative thinking and customer satisfaction. From planning to execution, we craft every little thing carefully and plan every square foot thoughtfully so you can make the most out of your living spaces.



Ethos Site Address:

Golecha Realty Corporation

Sr.No. 108/3/1A, Next to Akshara International School,
Behind Indira College, Wakad, Pune-57

Tel: 020 - 6511 5600 | www.grco.co.in | ethos@grco.co.in

DISCLAIMER

This brochure depicts an imaginary concept. The information contained in the brochure is indicative. The developers reserve the right to modify or cancel any plan or amenity, without any prior notice. This brochure is not part of any offer or contract.